

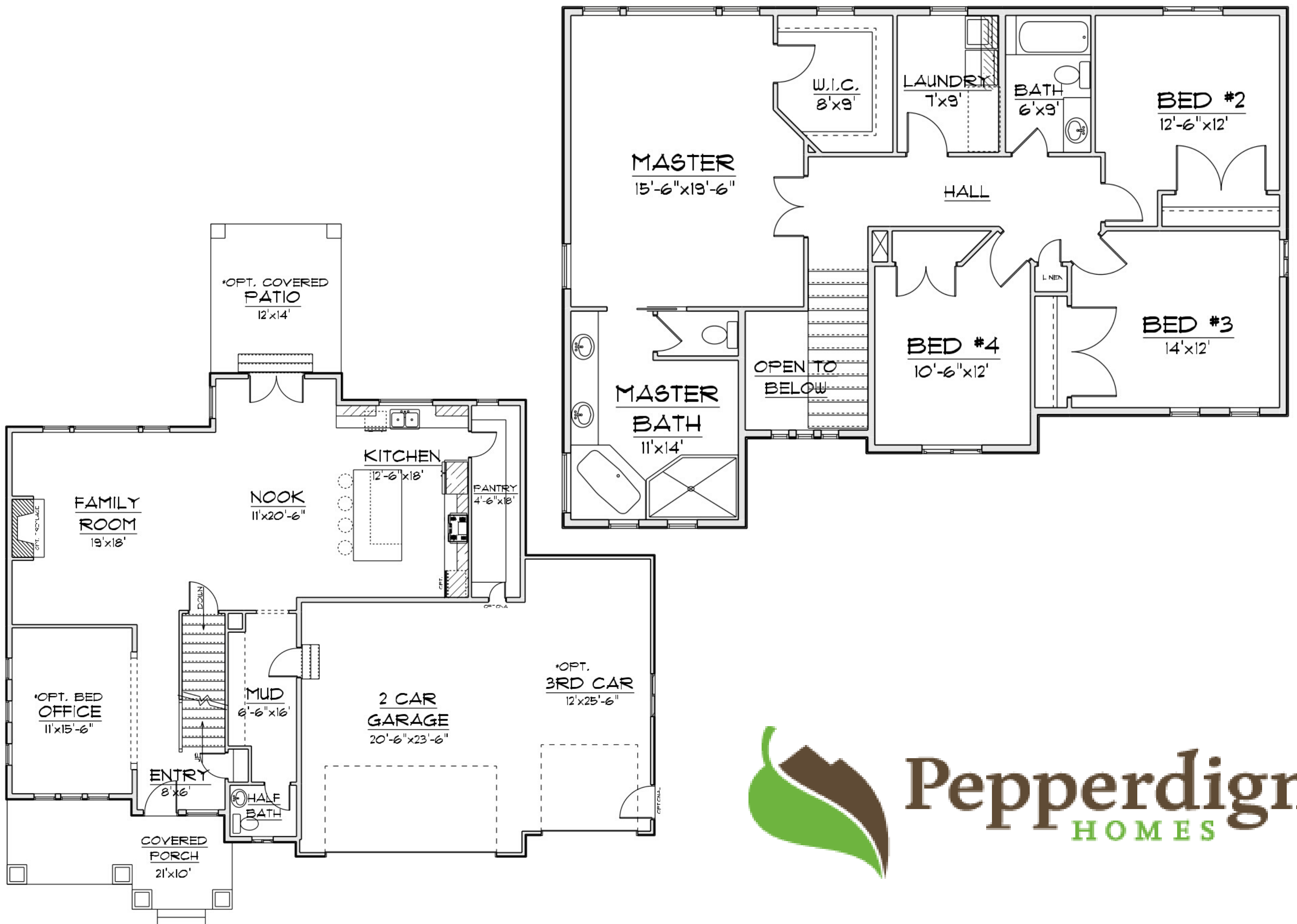

BAILEY

2-Story 1,438 SF Main Floor 1,364 SF Upper 1,438 SF Basement 4,240 SF Total
 4 Bedroom 2.5 Bath 3rd Car Optional Covered Patio Optional 48'-4" Wide x 50' Deep



Because Pepperdign Homes is consistently working to improve our products, policies and plans, items such as square footage, pricing, features, drawings, elevations, size and other options shown may change at any time and may be optional. The Builder reserves the right to change plans, material and policies without prior notice. Square footage, pricing, features, drawings, elevations and size are all approximations used for marketing and illustration purposes only and will vary per plan and lot.